

**Available space at Winter Park Station
Second Floor (Yellow Highlighted Area)**

**As of 1/1/2013
Call 970-281-7099**

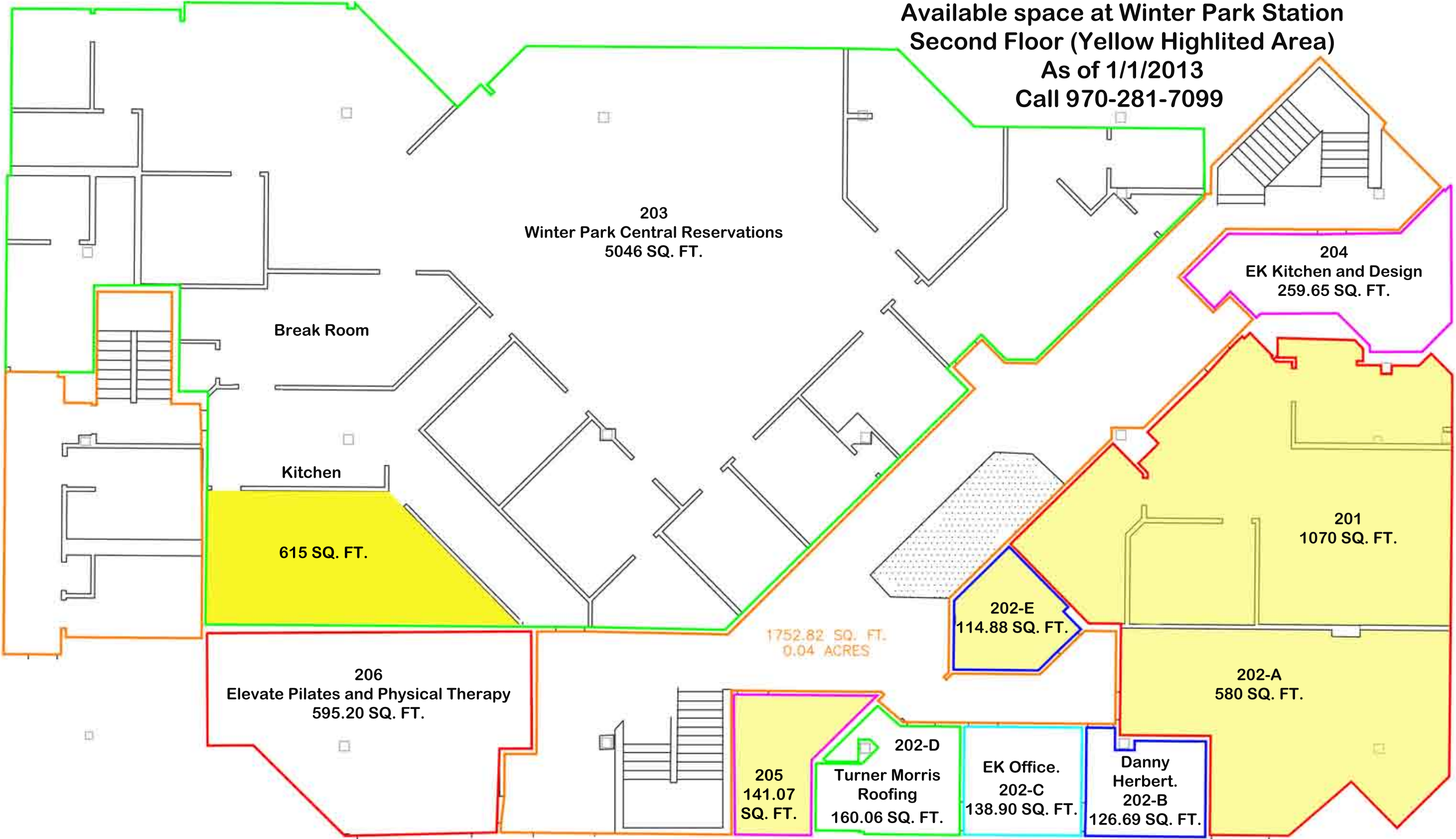

**203
Winter Park Central Reservations
5046 SQ. FT.**

**204
EK Kitchen and Design
259.65 SQ. FT.**

Break Room

Kitchen

615 SQ. FT.

**201
1070 SQ. FT.**

**202-E
114.88 SQ. FT.**

**1752.82 SQ. FT.
0.04 ACRES**

**206
Elevate Pilates and Physical Therapy
595.20 SQ. FT.**

**202-A
580 SQ. FT.**

**205
141.07
SQ. FT.**

**202-D
Turner Morris
Roofing
160.06 SQ. FT.**

**EK Office.
202-C
138.90 SQ. FT.**

**Danny
Herbert.
202-B
126.69 SQ. FT.**